

*From the desk of Amy Ho*

**For RENT: Fully Fitted Premium Office Space @ HAMPSHIRE PLACE, KLCC**

---

**Available: April-2025**

- Unit A-25-01, Level 25 | Size: 2,969 ft<sup>2</sup> | Rental: MYR 20,783 (MYR 7.00/ft<sup>2</sup>)
- Unit A-25-02, Level 25 | Size: 3,086 ft<sup>2</sup> | Rental: MYR 21,602 (MYR 7.00/ft<sup>2</sup>)
- Unit A-25-03, Level 25 | Size: 2,793 ft<sup>2</sup> | Rental: MYR 19,551 (MYR 7.00/ft<sup>2</sup>)

Hampshire Place Office, a 28-storey office building is strategically located in the Central Business District of downtown Kuala Lumpur, offering you easy access from both Jalan Ampang and Jalan Tun Razak while being a mere stone's throw away from other major attractions situated in the City Centre. The location of this building could be the next business landmark which provides convenience to tenants and clients alike.

Its contemporary design reflects today's modern stylish trends that radiates welcoming ambiance throughout. Hampshire Place Office provides ample office spaces for both communal and individual working environments. Equipped with facilities such as 24 hours security with high-tech CCTV, 6 high speed passenger lifts to reduce your travelling time within the building, Hampshire Place Office will surely present you with a remarkable dynamic work pleasure experience.

**Accessibility:**

- Ampang Park MRT Station – 5 mins walk
- Ampang Park LRT Station – 9 mins walk

**Car Parks**

- Total Parking Bays: 280
- Allocation of 1 parking bay per 1,000 sqft
- Floating: MYR 235.00/month
- Reserved: MYR 395.00/month



Contact Amy Ho @ +6012-332 1188 to schedule a viewing appointment today!

*From the desk of Amy Ho*

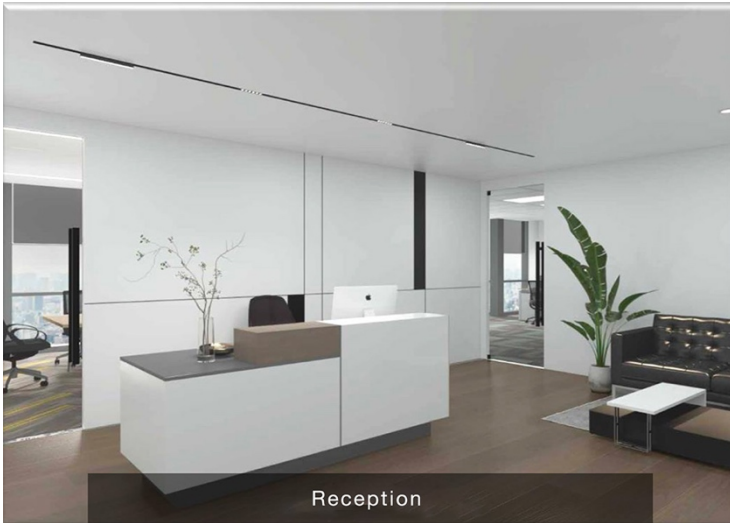

Reception

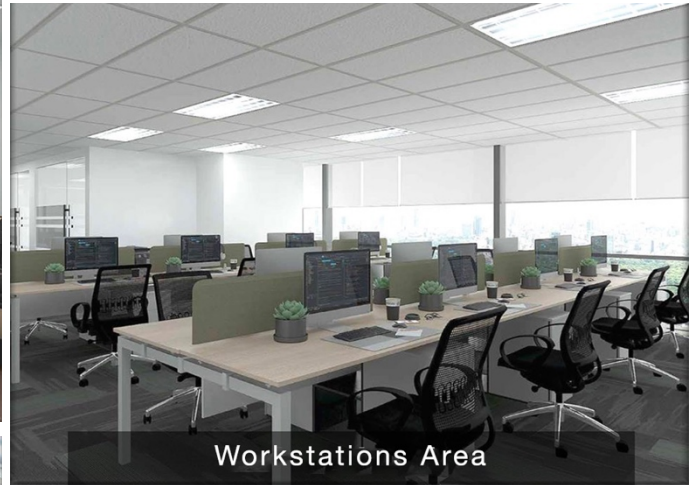

Workstations Area



Meeting Room

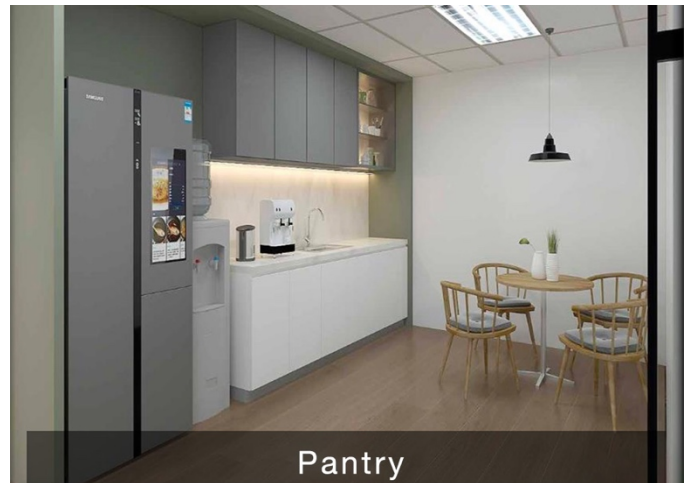

Pantry

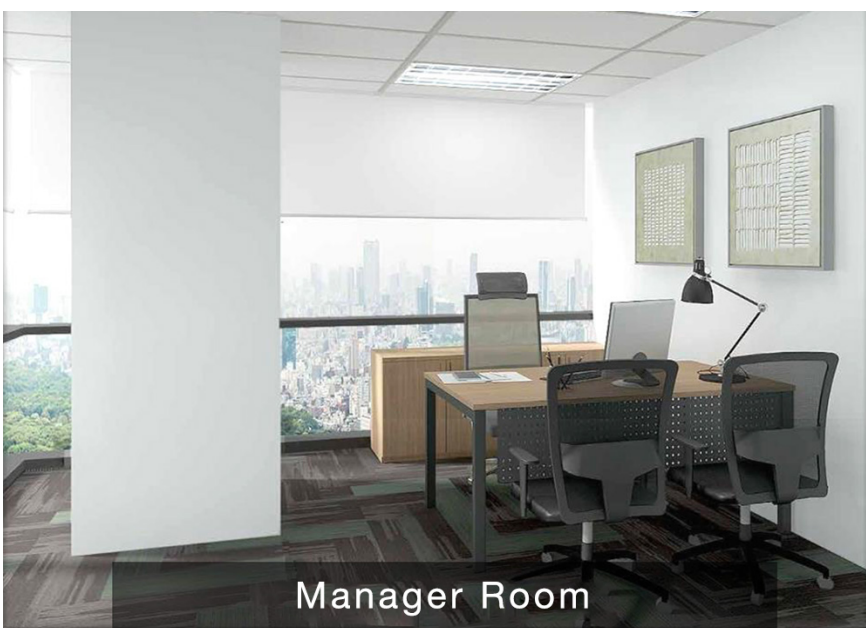

Manager Room

*From the desk of Amy Ho*

A-25-01 | 2,969 ft<sup>2</sup> | MYR 20,783/month

A-25-02 | 3,086 ft<sup>2</sup> | MYR 21,602/month

A-25-03 | 2,793 ft<sup>2</sup> | MYR 19,551/month

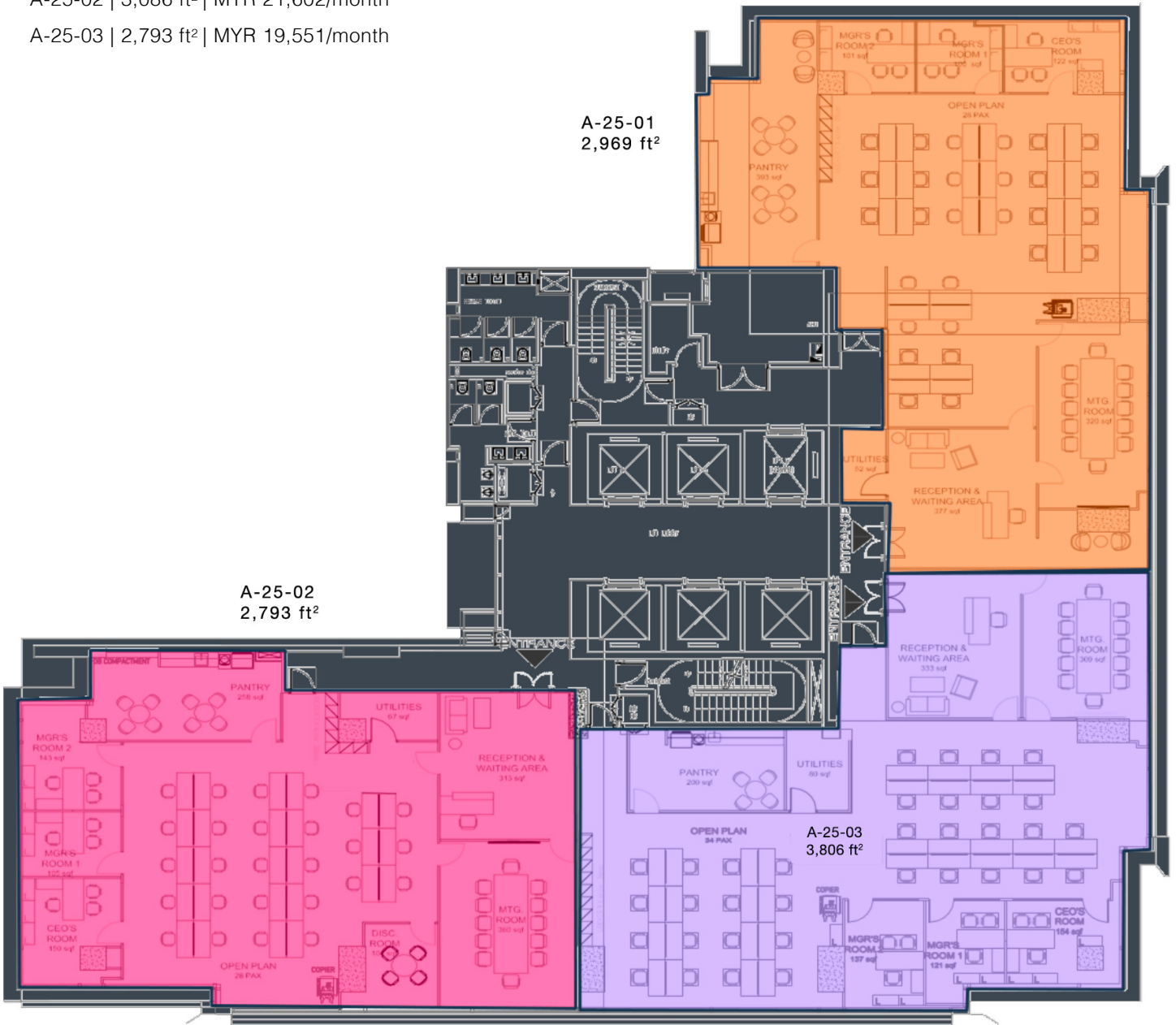



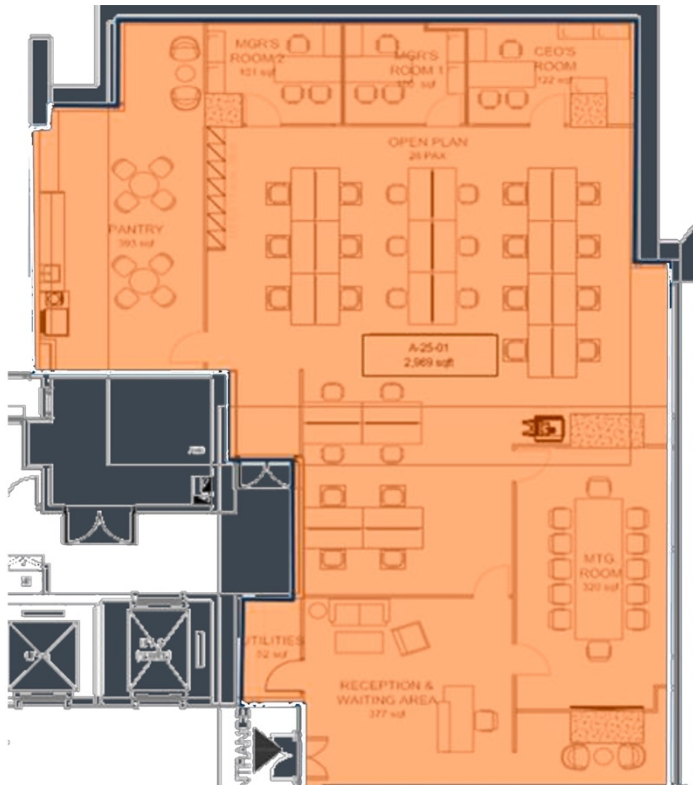

A-25-01 | 2,969 ft<sup>2</sup> | MYR 20,783/month

- 1 x CEO Room
- 2 x Manager Room
- 28 x Workstations
- 1 x Reception
- 1 x 12 Pax Meeting Room
- 1 x Pantry
- 1 Utility Room

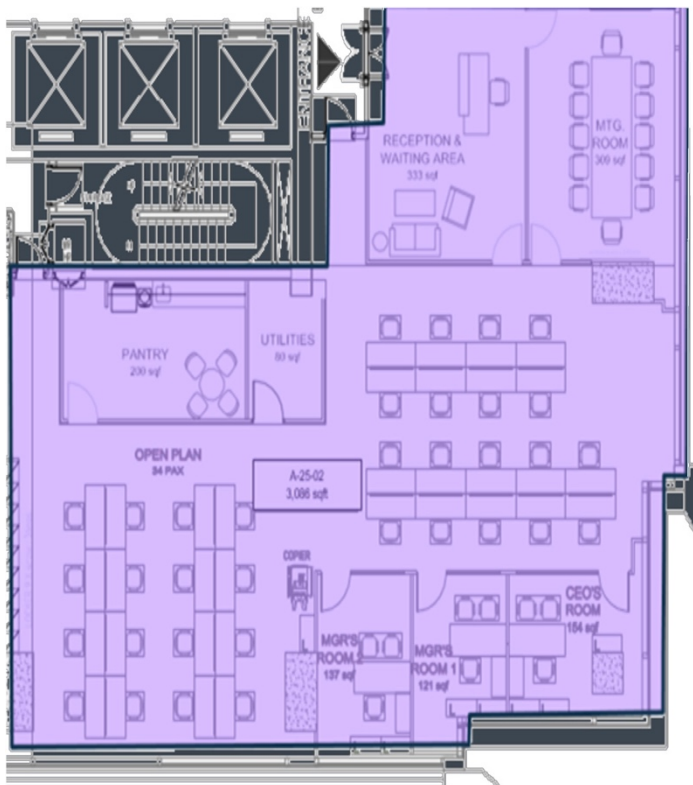

A-25-02 | 3,086 ft<sup>2</sup> | MYR 21,602/month

- 1 x CEO Room
- 2 x Manager Room
- 32 x Workstations
- 1 x Reception
- 1 x 12 Pax Meeting Room
- 1 x Pantry
- 1 x Utility Room

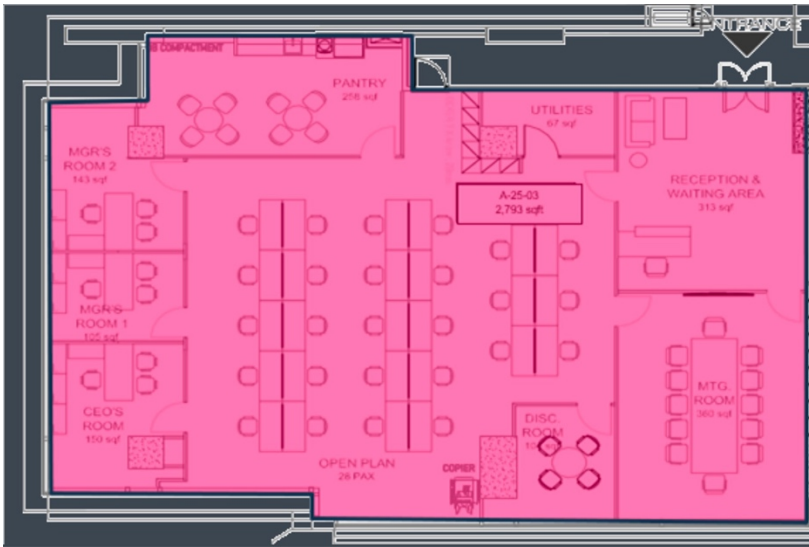

A-25-03 | 2,793 ft<sup>2</sup> | MYR 19,551/month

- 1 x CEO Room
- 2 x Manager Room
- 26 x Workstations
- 1 x Reception
- 1 x 12 Pax Meeting Room
- 1 x 4 pax Discussion Room
- 1 x Pantry
- 1 x Utility Room