

From the desk of Amy Ho

WISMA UOA DAMANSARA II @ DAMANSARA HEIGHTS

Rate: MYR 7.00/ft²

Premium Corner F&B Space for Rent on Ground Floor of Wisma UOA Damansara II

Asking Rental : MYR 13,083/month | MYR 7.00/ft²

Size : 1,869 ft²

Address : Changkat Semantan, Bukit Damansara, 50490 Kuala Lumpur.

Positioned prominently at the entrance of Wisma UOA Damansara II, this F&B space enjoys unparalleled visibility from both Jalan Semantan and Changkat Semantan, thanks to its corner location on the ground floor. Take inspiration from The Ploy, a thriving Japanese-Thai restaurant just next door at Clear Water Residence, successful for over a decade.

Wisma Damansara II is a 16-story Grade A office tower boasting MSC Status and modern elegance. Its eye-catching glass façade and spacious, secure double-volume lobby affirm its contemporary allure.

The locale is rich with high-end amenities. Think reputable banks, luxury serviced apartments, gourmet dining, exclusive shopping, and top-notch schools—all within arm's reach. Plus, with Semantan MRT Station just a short walk away, this spot is an irresistible draw for businesses.

Contact Amy Ho @ +6012-332 1188 to schedule a viewing today!



From the desk of Amy Ho

FLOOR PLAN

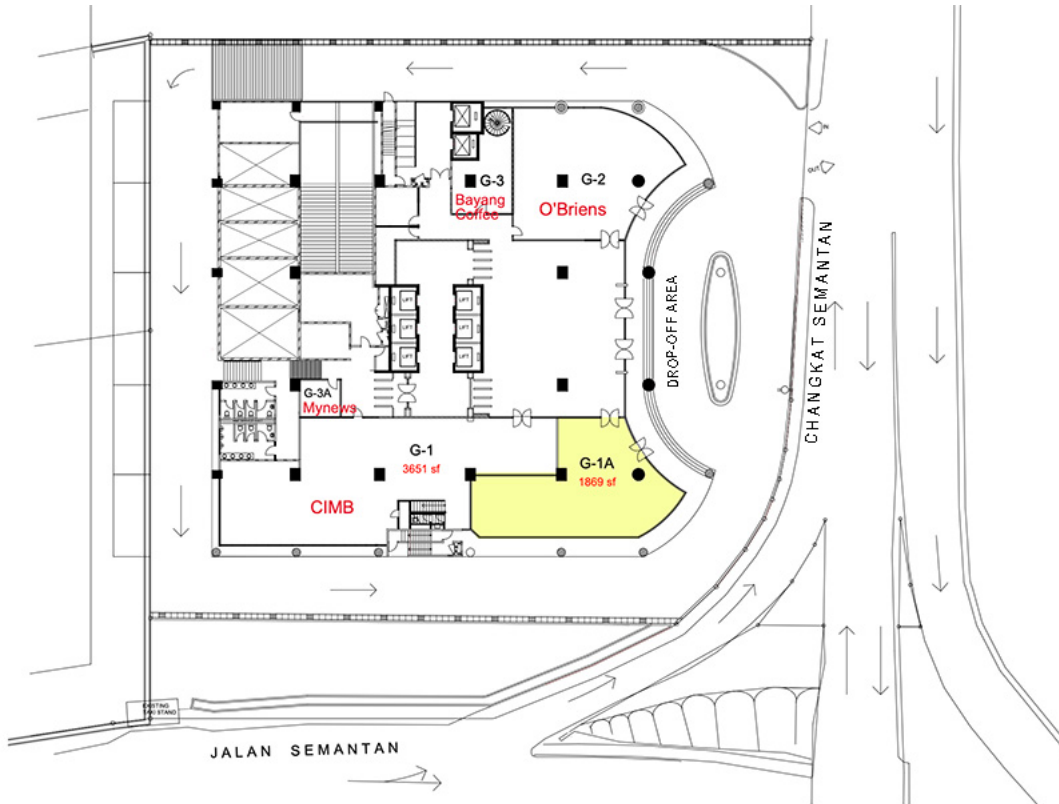

From the desk of Amy Ho



From the desk of Amy Ho

WISMA UOA II, DAMANSARA HEIGHTS

