

For RENT: Fully Fitted Premium Office Space @ G Tower

Available: April-2025

- Unit 14-03 & 06, Level 14 | Size: 3,174 ft² | Rental: MYR 25,392 (MYR 8.00/ft²)
- Unit 16-11 & 14, Level 16 | Size: 3,185 ft² | Rental: MYR 25,480 (MYR 8.00/ft²)
- Unit 18-11 & 14, Level 14 | Size: 3,185 ft² | Rental: MYR 25,480 (MYR 8.00/ft²)
- Unit 21-10 & 12, Level 21 | Size: 2,540 ft² | Rental: MYR 20,320 (MYR 8.00/ft²)
- Unit 21-11 & 14, Level 21 | Size: 3,187 ft² | Rental: MYR 25,496 (MYR 8.00/ft²)

G Tower is a Grade A office building located along Jalan Tun Razak, in the heart of Kuala Lumpur's Golden Triangle. It is renowned for being Malaysia's first Green Building Index (GBI) certified office tower, offering an eco-friendly and energy-efficient working environment.

Key Features:

- Prime Location – Strategically situated next to the Ampang Park LRT station, providing easy access to public transport and major highways.
- Premium Office Spaces – Features modern office suites, co-working spaces, and corporate floors catering to various business needs.
- Green & Sustainable Design – Built with energy-efficient systems and eco-conscious materials.
- Excellent Amenities – Includes executive lounges, business meeting rooms, gym facilities, and rooftop dining.
- Nearby Landmarks – Close to KLCC, The Intermark, and major embassies.

Accessibility:

- Ampang Park LRT Station – 2 mins walk
- Persiaran KLCC MRT Station - 5 mins walk
- Ampang Park MRT Station – 5 mins walk
- Major Highways – Easy access to Jalan Tun Razak, MEX, and DUKE

Car Parks

- Total Parking Bays: 1038.
- Visitor Parking: B1 & B2 (247 bays),
- Tenant Parking P1-P6: 791 bays
- Allocation of 1 parking bay per 1,000 sqft
- Floating: MYR 235.00/month
- Reserved: MYR 395.00/month

G Tower is a top choice for corporations, financial institutions, and multinational companies looking for a prestigious business address in Kuala Lumpur.

Contact Amy Ho @ +6012-332 1188 to schedule a viewing appointment today!

From the desk of Amy Ho



G Tower

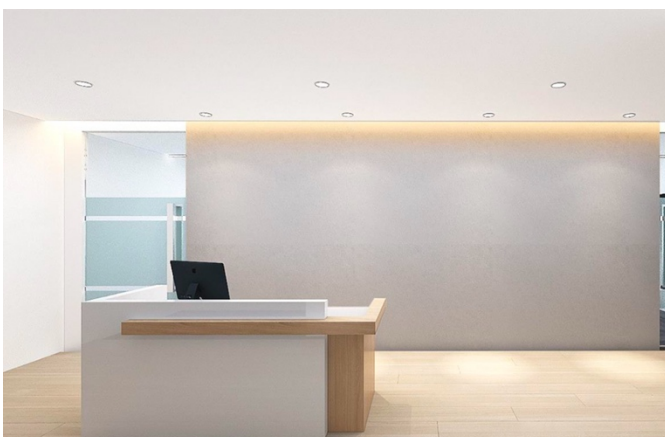

Reception

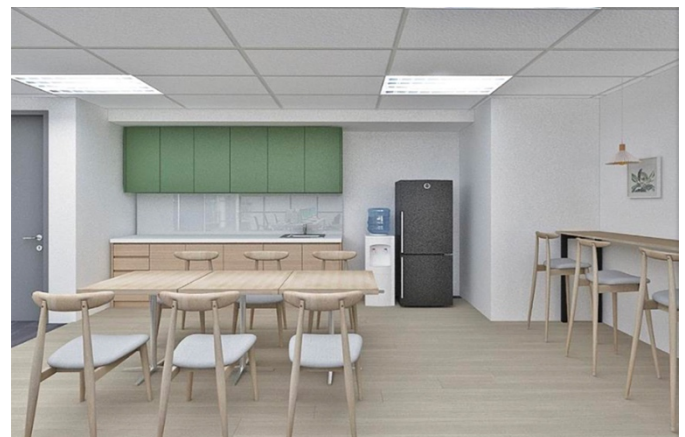

Pantry

From the desk of Amy Ho



Meeting Room

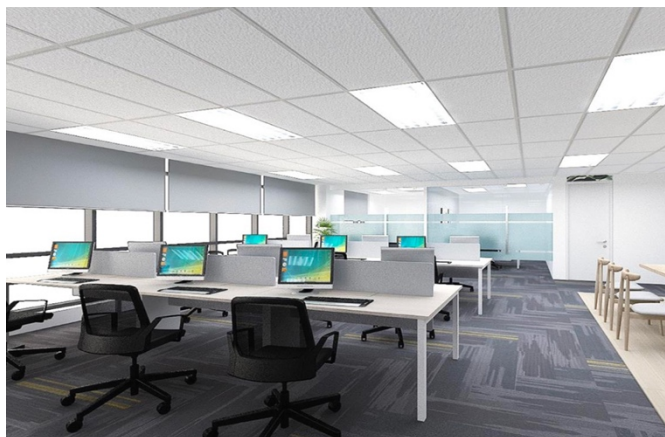

Workstations

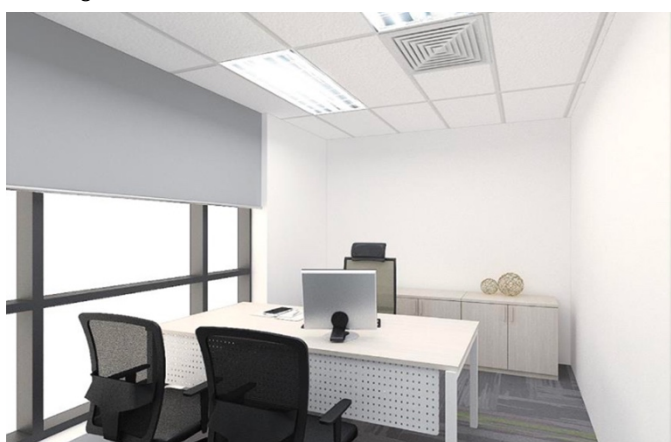

Manager Room

Suite 14-03 & 06 | Size: 3,174 ft² | Rental MYR 25,392/month

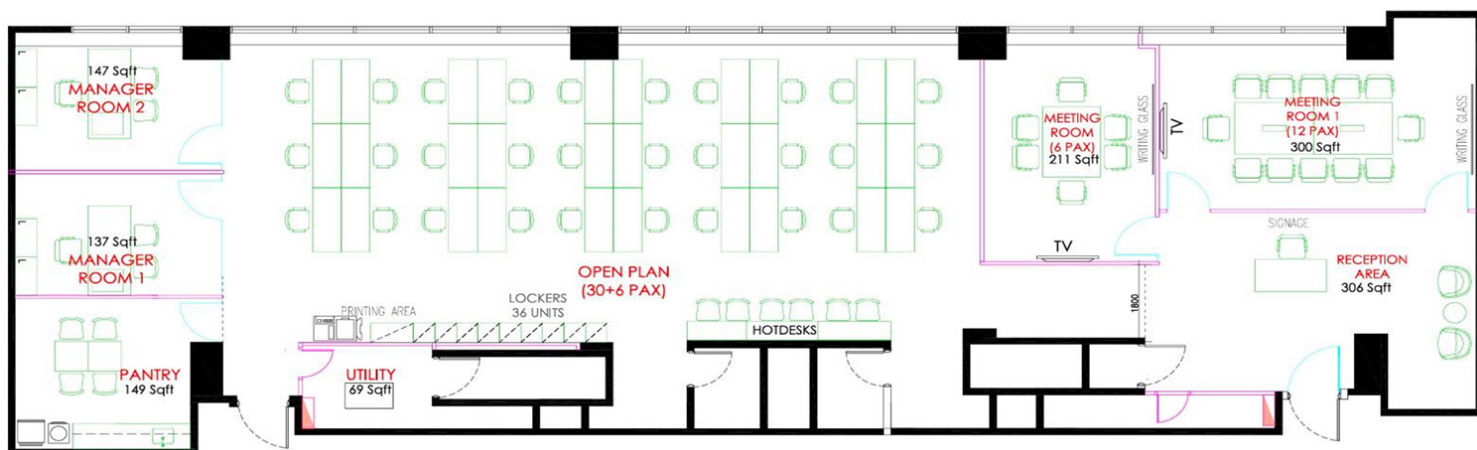

- | | |
|-----------------------|-------------------------|
| 2 Manager Rooms | 30 Workstation |
| 6 Hot Desks | 1 Meeting Room (12 pax) |
| 1 Meeting Room (6Pax) | 1 Reception |
| 1 Pantry | 1 Utility Room |
| 2 Internal Toilets | |

Suite 16-11 & 14 | Size: 3,185 ft² | Rental MYR 25,480/month

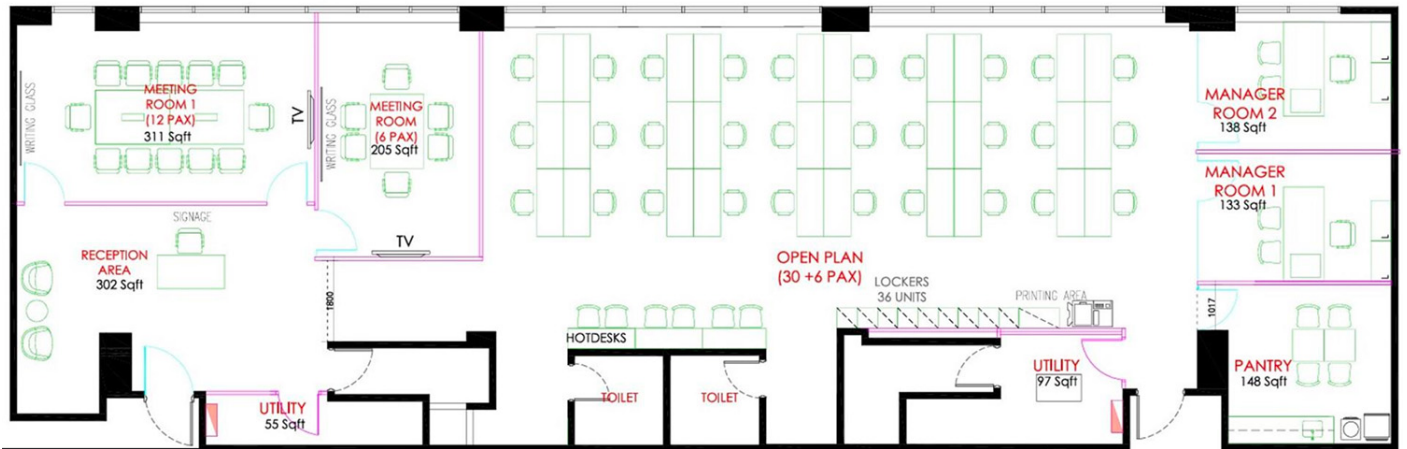

- 2 Manager Rooms
- 6 Hot Desks
- 1 Meeting Room (6Pax)
- 1 Pantry
- 2 Internal Toilets
- 30 Workstation
- 1 Meeting Room (12 pax)
- 1 Reception
- 2 Utility Rooms

Suite 18-11 & 14 | Size: 3,185 ft² | Rental MYR 25,480/month

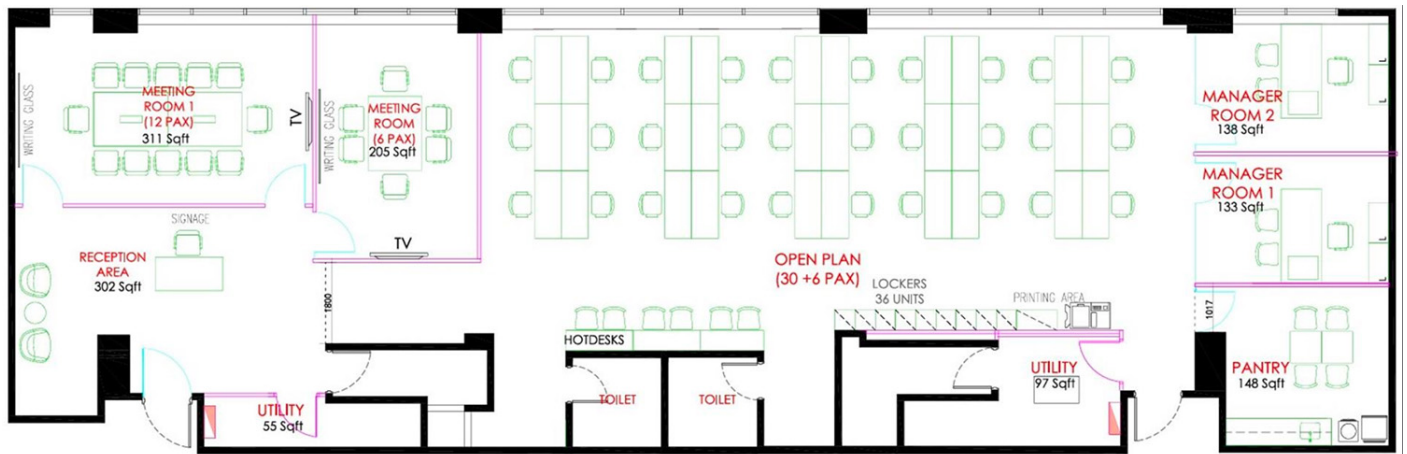

- 2 Manager Rooms
- 6 Hot Desks
- 1 Meeting Room (6Pax)
- 1 Pantry
- 2 Internal Toilets
- 30 Workstation
- 1 Meeting Room (12 pax)
- 1 Reception
- 2 Utility Rooms

From the desk of Amy Ho

Suite 21-10 & 12 | Size: 2,540 ft² | Rental MYR 20,320/month

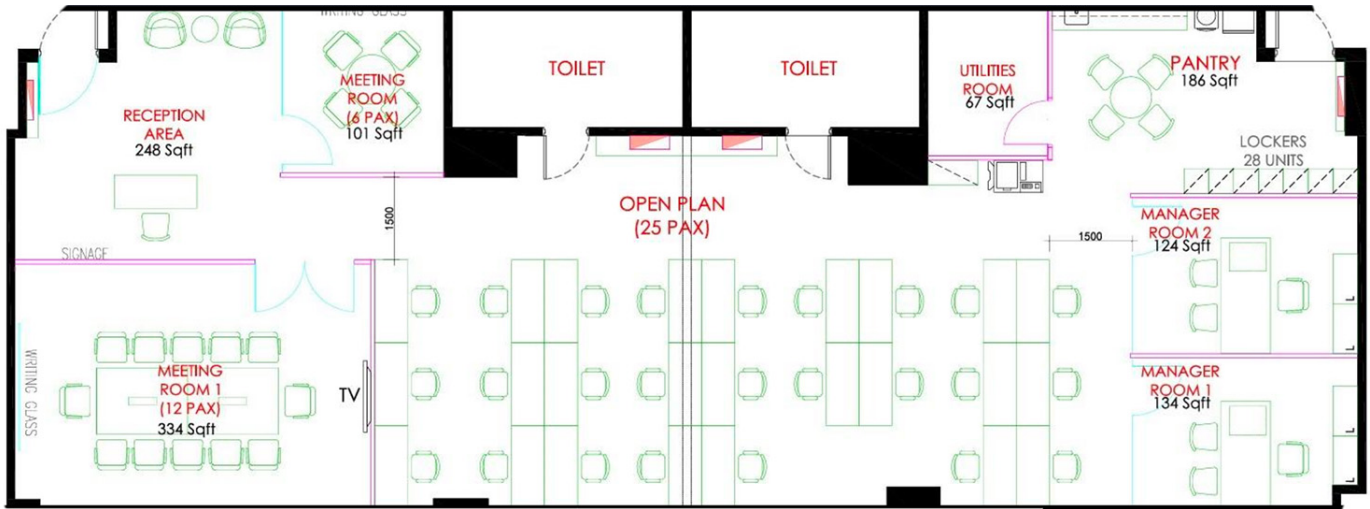

- | | |
|-------------------------|-----------------------|
| 2 Manager Rooms | 25 Workstation |
| 1 Meeting Room (12 pax) | 1 Meeting Room (6Pax) |
| 1 Reception | 1 Pantry |
| 1 Utility Room | 2 Internal Toilets |

Suite 21-14 & 16 | Size: 3,187 ft² | Rental MYR 25,496/month

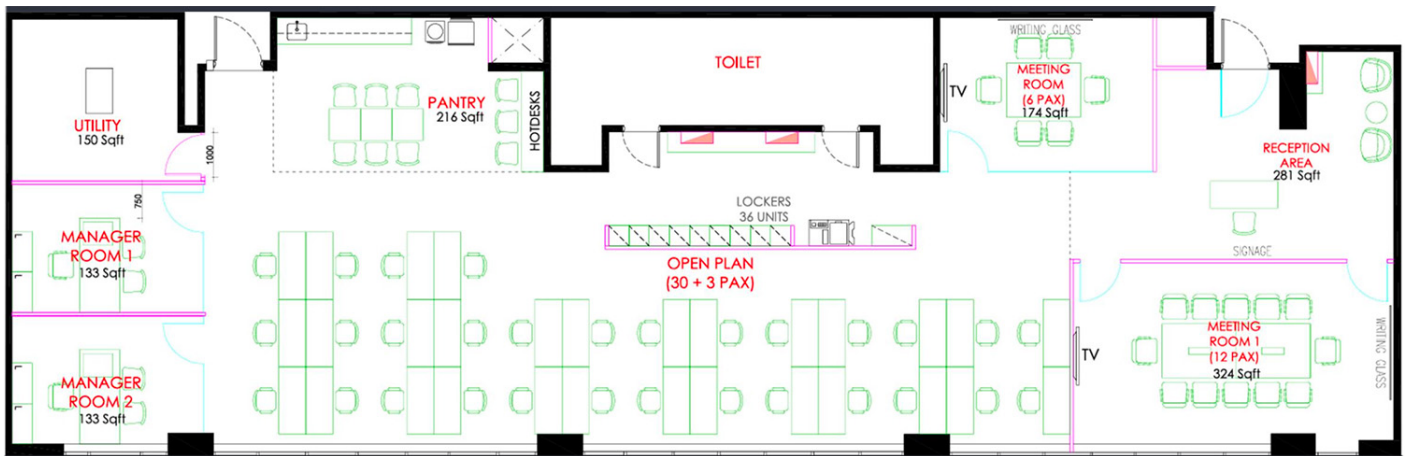

- | | |
|-----------------------|-------------------------|
| 2 Manager Rooms | 30 Workstation |
| 3 Hot-Desks | 1 Meeting Room (12 pax) |
| 1 Meeting Room (6Pax) | 1 Reception |
| 1 Utility Room | 1 Pantry |
| | 2 Internal Toilets |