

For RENT: PREMIUM OFFICE SPACE @ VERTICAL BUSINESS SUITES, TOWER A

---



The Vertical Business Suites Tower A, part of the prestigious twin towers at The Vertical, offers breathtaking lake, park, and city views. Intelligently designed to meet the spatial and operational needs of Small and Medium Enterprises (SMEs), this tower presents an exceptional opportunity for your business.

Key Features:

- 35-storey tower, houses 420 individual business suite units,
- Office spaces ranging from 735 ft<sup>2</sup> to 13,664 ft<sup>2</sup>
- Grand double-volume lobby
- Air-conditioned corridors
- Private and common restrooms
- 24-hour security with card access, and CCTV
- 10 high-speed lifts

Location:

- Situated within the MSC Malaysia Cybercentre @ Bangsar South City
- Connected to various recreational venues offering diverse dining, shopping, and lifestyle experiences within Bangsar South

Accessibility:

- Direct link bridge to Nexus
- Walking distance to Universiti Station and covered link bridge to Kerinchi LRT Station
- Easy access to Federal Highway, NPE (New Pantai Expressway), and Sprint Highway

Positioned in one of Kuala Lumpur's most desirable locales, The Vertical Business Suites is set to become the premier business and lifestyle destination for the city's dynamic urban dwellers. With thoughtfully designed office suites tailored to SMEs, The Vertical not only provides a prestigious business address but also a promising investment opportunity.

RENTAL RATES & AVAILABILITY

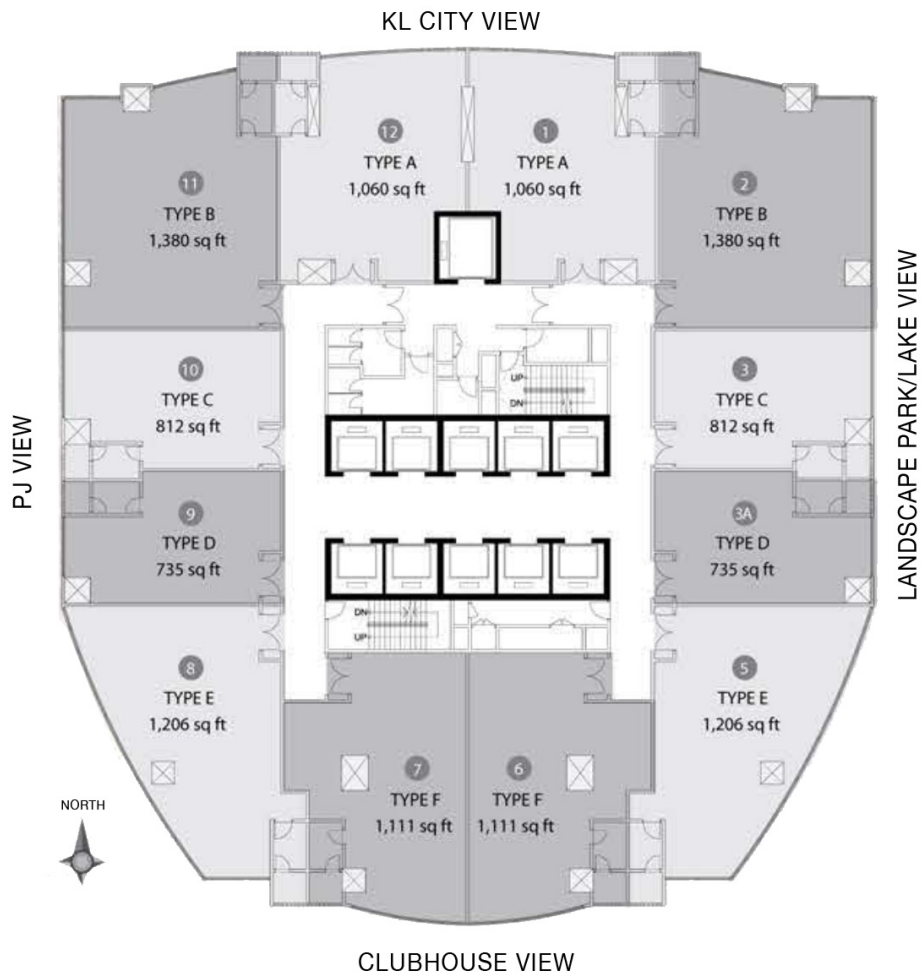

<u>Level</u>	<u>Built-up in feet<sup>2</sup></u>	<u>Furnishing/Remarks</u>	<u>Rental rate</u>
13 <sup>th</sup> Floor	1,206 ft <sup>2</sup>	Bare unit	MYR 4.80 – MYR 5.00/ft <sup>2</sup>
14 <sup>th</sup> Floor (13A)	1,206 ft <sup>2</sup>	Bare unit	MYR 4.80 – MYR 5.00/ft <sup>2</sup>
22 <sup>nd</sup> Floor	1,206 ft <sup>2</sup>	Bare unit	MYR 4.80 – MYR 5.00/ft <sup>2</sup>

FLOOR PLAN



LOCATION



-  The Vertical II Office Suites
-  Future Developments
-  Link Bridge/Pedestrian Walk

*From the desk of Amy Ho*

THE VERTICAL BUSINESS SUITES

